

BREATHALYZER ACE 3000



- 1 Mouthpiece
- 2 Indicator "device ready"
- 3 Indicator for battery (if it needs recharging)
- 4 Breath outlet (do not cover with your hand)
- 5 Red warning signal (if breath alcohol content exceeds 0.50‰)
- 6 On / Off button
- 7 DC car adapter

The Test

Do not drink alcohol 20 minutes prior to the test – rinse mouth with water –
Do not smoke 3 minutes prior to the test
Apply mouthpiece - press black button. A sequence of numbers will count down from 200 to 000, then you will hear a beep and the green light - "device ready"- will come on.
Now you have to blow **strongly for about 4 seconds** without interruption until the beep.

The sample is taken correctly only if both the green AND the red light flash at the same time.
Starting at 0.50 ‰ an alarm sound is emitted and the red light flickers.

If you do not blow into the device within 30 seconds after the green light comes on, the device will automatically turn off. Please additionally switch off with the black button. Please wait for 2 minutes between tests. To prepare the device for the next testing procedure press the black button again.

The measuring principle

There is a strong connection between blood and breath alcohol. Deep inside the lungs, in the alveolars, blood and breath are separated by a thin, gas-permeable membrane. It is here that the exchange of gas takes place
Oxygen is absorbed by the blood, carbon dioxide and, where present, alcohol are released into the exhaled air.
To obtain this kind of air from the depth of the lungs (air from the alveolars) for analysis a certain minimum amount of breath has to be exhaled.
(1.2 litres of breath = 4 seconds of strong blowing)
The correct testing results can be achieved only if you blow hard and the sufficient amount of breath is exhaled.

Your "BREATHALYZER ACE 3000" is designed to protect you from harm and to prevent misunderstandings in the event of a police check

BREATHALYZER ACE 3000

ACE 3000

The ACE 3000 is a breath alcohol-testing device that uses microcomputer technology. It is small, handy and easy-to-use. Accuracy is dependent on the correct use and careful treatment of the breath alcohol-testing device.

ACE 3000 at work

Alcohol at work- a factor not to be underestimated in terms of safety within the company and frequently a considerable risk for the responsible superior.

ACE 3000 in traffic, in companies and in clinics

Not only the police have access this kind of measuring devices, they are now also available for companies, clinics and private individuals for necessary tests.

ACE 3000 Technical Data

Display: 3-digit numbers (0.00) In case of high testing results above 5‰, the display will read "HOT"

Size: W x L x H 60 x 120 x 25 mm

Weight: **Only 130 grams including battery!**

Battery: 9 volt alkaline

Accuracy: +/- 10% at 1.00 ‰

The accuracy of the testing pipes used for years now amounts to only about 20-25% (also due to reading difficulties)

The device should be recalibrated after 6- 12 months

Warranty: 12 months
if handled correctly

Hints for replacing the batteries when the light "BATT LOW" is on.

N.B. Slide the lid in, never push it down.

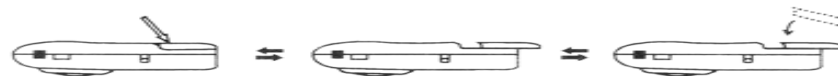

Important:

The limits for unfitness to drive vary in different countries. Regardless of that, a lower level of blood alcohol such as 0.2 – 0.4 ‰ might also lead to impairment due to individual alcohol tolerance and therefore result in unfitness to drive and therefore a punishable offence. In Germany you have to be aware that a blood alcohol level of only 0.30 ‰ might be considered a punishable offence and a fine might be imposed in the event of bad driving.

A test with the ACE 3000 does not count as evidence for the police, but it does give you an important indication of how to behave responsibly in traffic.

The ACE 3000 was calibrated prior to delivery.

To ensure correct measurement it should be recalibrated every 6 months. Please send the device to us for this purpose.

Cost of calibration €30.00 incl. VAT and shipping. Duration: 7 days.

INSTRUCTIONS ACE ENGLISH

Your "BREATHALYZER ACE 3000" is designed to protect you from harm and to prevent misunderstandings in the event of a police check